

VANDAL-PROOF SWITCHES

These pushbuttons are tamper-proof and weather resistant up to IP65, impact resistant up to IK09 and feature all metal body made from corrosion resistant materials such as stainless steel, anodised aluminium or nickel plated brass. They are stylish, compact, robust and feature 12V illuminated LED or non-illuminated and silver alloy switch contacts.

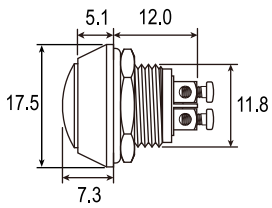

IP65
IK09

24930

Black zinc alloy body.
Momentary SPST.
12mm hole.
Screw terminals.
2A/48VDC.



IP65
IK09

24931

Red zinc alloy body.
Momentary SPST.
12mm hole.
Screw terminals.
2A/48VDC.



IP65
IK09

24932

Stainless steel body.
Momentary SPST.
12mm hole.
Screw terminals.
2A/48VDC.

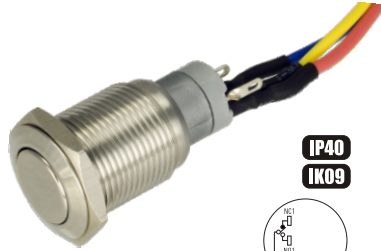
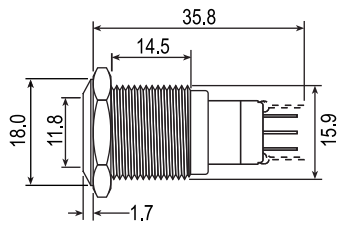

IP40
IK09

24942

Stainless steel body.
Latching SPDT.
16mm hole.
Pre-wired.
3A/250VAC - 2A/48VDC

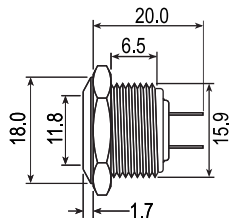

IP65
IK09

24941

Nickel plated brass body.
Momentary SPST.
16mm hole.
Solder tabs.
3A/250VAC - 2A/48VDC

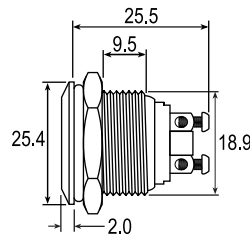

IP65
IK09

24951

Stainless steel body.
Momentary SPST.
19mm hole.
Screw terminals.
3A/250VAC - 2A/48VDC

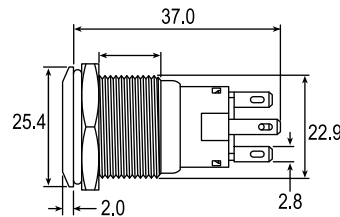

IP65
IK09

Stainless steel pushbutton
Momentary SPDT
19mm hole
12V LED dot illuminated
3A/250VAC - 2A/48VDC
24952 - Red
24953 - Blue
24954 - Green

Stainless steel pushbutton
Latching SPDT
19mm hole
12V LED dot illuminated
3A/250VAC - 2A/48VDC
24956 - Red
24957 - Blue
24958 - Green

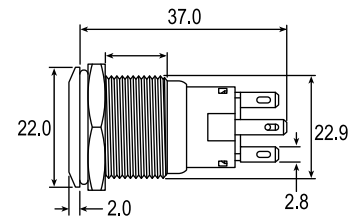

IP40

24987

Black anodised aluminium alloy body.
Blue 12V LED ring illumination.
Latching SPDT.
19mm hole. Pre-wired.
3A/250VAC - 2A/48VDC

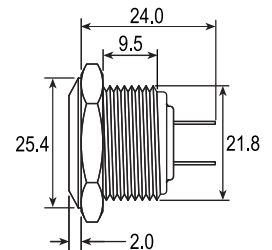

IP65
IK09

24971

Stainless steel body.
Momentary SPST.
22mm hole.
Solder tabs.
3A/250VAC - 2A/48VDC